



Congratulations and a warm welcome to the World of Propello Water Purification Systems.

The Splash Alkaline RO is a result of our constant endeavor to provide 100% Pure and Healthy drinking water.

The Splash Alkaline RO water purifier uses Reverse Osmosis Technology to remove all kinds of impurities, Chemicals and Micro-organisms. This technology also removes the hardness of water. The Splash Alkaline RO helps to improve PH level.

The Splash Alkaline water purifier uses Alkaline Cartridge to maintain the necessary amount of minerals in the water . With the use of RO Technology and other filtration stages the Splash Alkaline RO water purifier ensures that you get the purest drinking water.

Here's wishing you and your family a happier and healthier life

With Warm Regards,

Propello Family

The Table below gives an insight on how chemical impurities can impact your health

Chemical Constituent	Requirement (Acceptable limit) IS10500-2012 Drinking water specification	Undesirable effect outside the desirable limit
Total Hardness as CaCO ₃ mg/lit, max	200	Encrustation in water supplying structure and adverse effects on domestic use
Total dissolved solids	500	Beyond this palatability decreases and may cause gastro intestinal irritation
Iron as Fe mg/lit, max	0.3	Beyond this limit taste, appearance are affected, has adverse effect on domestic uses and water supplying structures. It also promotes iron bacteria
Chlorides as CL mg/lit, max	250	Beyond this limit taste corrosion and palatability are affected
Nitrate as NO ₃ , mg/lit, max	45	Beyond this methaemoglobinemia takes place
Fluoride as F mg/lit, max	1	Fluoride should be kept as low as possible. High fluoride may cause fluorosis
Mercury as Hg mg/lit, max	0.001	Beyond this limit the water becomes toxic
Arsenic as As mg/lit, max	0.01	Beyond this limit the water becomes toxic
Lead as Pb mg/lit, max	0.01	Beyond this limit the water becomes toxic

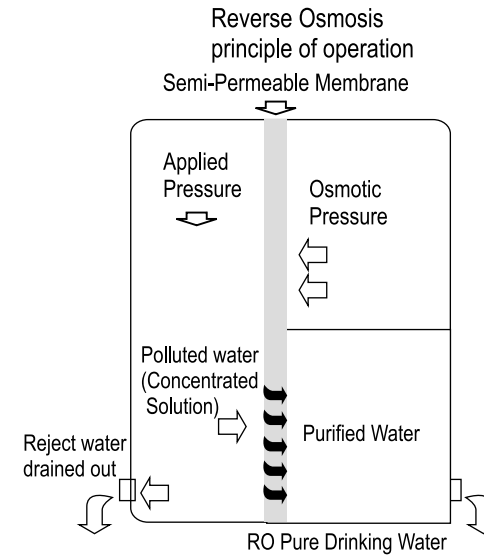

What is Osmosis?

In living cells movement of liquids takes place through a semi-permeable membrane separating solutions of different concentrations. Passage of water from weak solution to through a semi permeable membrane is called osmosis.. Osmosis is a vital mechanism in the transport of fluids in living organisms, for example, uptake of water from the earth and also transport of water between cells in case of plants.

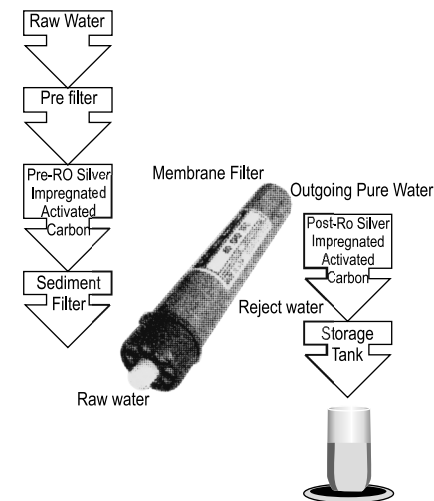

What is Reverse Osmosis?

Reverse Osmosis (RO) is when osmosis is reversed by applying external pressure to the more concentrated (polluted side). The water is forced through a synthetic semi permeable membrane that allows only water(H₂O) molecules. When pressure is applied to the concentrated solution, the water passes through the membrane and the rest is left behind, to be drained out.

In the Reverse Osmosis System, water is pushed under high pressure through a very fine membrane of pore size 0.0001 micron. So the water that comes through the membrane filter is free from total dissolved solids, hardness, micro-organisms, chemicals, other metal contaminants, particles and VOC.

Salient Features

- Suitable for mounting or counter-top installation.
- Purification by RO
- 8 litre storage capacity
- RO membrane fused inside membrane housing to prevent tampering
- External SMPS Adaptor for water protection
- Push-fit components for leak-proof & maintenance free performance
- Fully automatic operation with auto-on and auto-off
- ABS construction for corrosion-free lifespan
- Equally suitable for water from all sources

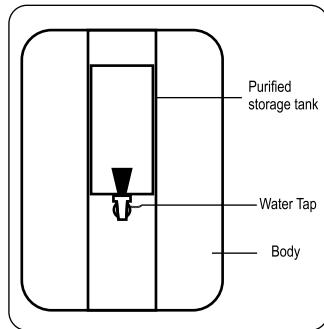

- Splash Alkaline Reverse Osmosis System provides close to 100% removal of almost all unwanted and harmful substances
- LPS prevents the pump from dry running in case the overhead tank is empty
- Automatic Float Level Micro-switch controls the water level automatically and shuts off the pump when the storage tank is full

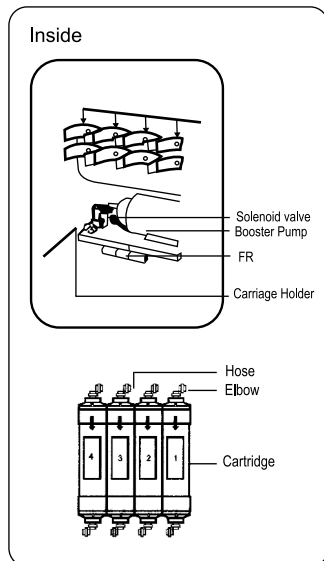

- The Splash Alkaline Reverse Osmosis System will enhance any home with functionality and so in style!

Additional Benefits of Splash Alkaline RO

- You can truly get the flavours of coffee and tea with Splash Alkaline RO
- True flavours and aromas of all cooked foods will be experienced.
- Ice cubes will be clear and sparkling
- Appliances that use water (your steam iron/electric kettle) will be more effective and last

Salient Features

RO Technology :

Unique RO Technology membrane removes excess TDS, blocks dissolved impurities and chemical contaminants, while retaining essential minerals in the drinking water.

Alkaline Cartridge:

- Ø Make the water nutrient, by providing essential minerals.
- Ø It provides healing effects and improves health immunity
- Ø Enhance the taste of water.
- Ø It balances the pH level of your drinking water.
- Ø It helps in protecting the storage tank water from external bacterial contamination.

Total Protection:

Eliminates tough new age contaminants like lead, pesticides and heavy metals from water. It also ensures that water is free from disease-causing bacteria, virus and protozoa.

Large Storage Capacity:

It comes with a 8-litre in-built storage tank. Thereby ensuring purified water on tap, all the time.

The 8 stages Splash Alkanine RO are as follows:

Stage	Component	Function
1	Iron Filter	Helps in removing dissolved iron from water
2	Pre-filter yarn polypropylene	Removes suspended impurities like dirt mud, rust, sand etc.
3	Anti-scalant	Helps improving the life of the RO membrane
4	Pre-carbon Filter Silver impregnated Activated Carbon	Removes excess chlorine, bad odour, colour, bad taste and organic impurities and organic impurities
5	Sediment Filter Melt blown Yarn polypropylene	Removes fine particles such as dirt, dust, mud and sand
6	Reverse Osmosis Membrane Thin Film Composite (TFC) 0.0001 micron	Removes TDS, hardness, fluoride, pesticides, VOC, heavy metals like lead, mercury, cadmium & Arsenic etc. Removes micro-organisms like bacteria, viruses and protozoan cysts.
7 & 8	Alkaline Cartridge & Post RO Carbon	<ul style="list-style-type: none"> ➤ Make the water nutrient, by providing essential minerals. ➤ It provides healing effects and improves health immunity. ➤ Enhance the taste of water. ➤ It balances the pH level of your drinking water. ➤ It helps in protecting the storage tank water from external bacterial contamination.

Water Flow Diagram

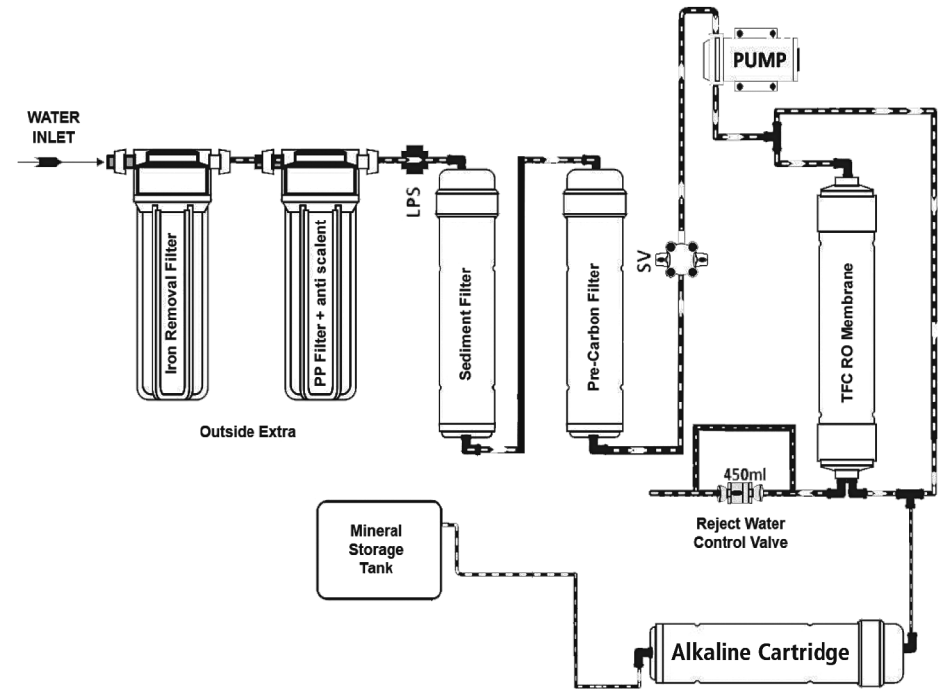

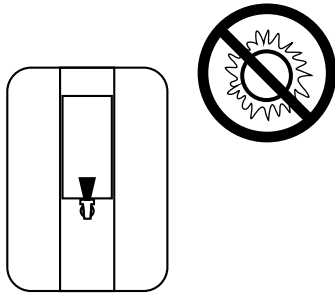

Install it in a dry ventilated place

- Keep it away from direct sunlight or below freezing temperatures. Connect it to only cold tap water
- Filters can be damaged if connected to hot tap water
- Make sure that the tap water pressure is max.2.0kg/sq.cm if the tap water pressure you receive is higher than the maximum specified, the use of a pressure reducing valve is recommended. The above accessory is available with our company at an additional cost.
- If not, water might flow back into the purifier.
- Make sure that the purifier is installed within the distance of 1m (max) from the tap water supply.
- This purifier is for 230V only so make sure that you connect to a 230V power outlet.
- Do not install the purifier in a place where water of rain could leak into it (Outdoor etc.).

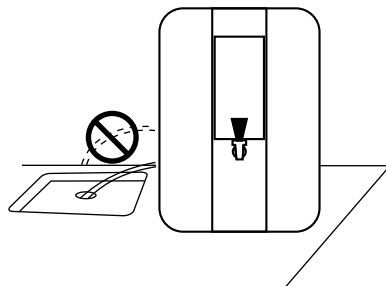
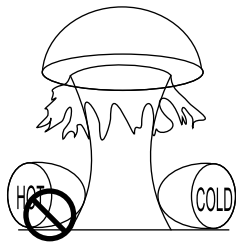

Water is a rapidly depleting source. It is our moral responsibility to ensure that water is recycled as much as possible. The water flushed by Wave can be used for

Can be used for Watering plants

This water can be used for watering plants.

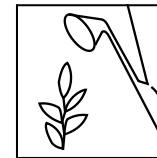

Cannot be used for

Cleaning utensils, daily household cleaning, washing clothes and drinking purpose



Check points before calling our Service Department

Before you panic and call our service department, here are some simple steps to be followed. Most times you'll find that one or a combination of these will solve the problem/s. When these steps at your end fail then immediately call our helpline/service department and we will take up your case on priority. Thank You.

Problem	Check Points	Solutions
Water tastes bad	<ol style="list-style-type: none"> 1. Is the storage tank clean? 2. Have you kept the purified water in the tank too long? 3. Is it time to change filters? 	<p>Dispose off water and clean the tank.</p> <p>Call our service department to change filters.</p>
Here is too much or too little water being purified	<ol style="list-style-type: none"> 1. Is the tap water valve closed? 2. Is the tap water temperature too low? 3. Filters may be clogged or damaged. 4. Pump or SV has failed. 	<p>Open the tap water valve.</p> <p>If so, the amount of purified water will be reduced.</p> <p>Call our service department and change filters.</p> <p>Call Service department to rectify/change</p>
Water doesn't come out.	<ol style="list-style-type: none"> 1. Is there water in the tank? 2. Is tap water supplied? 3. Is the tap water valve closed? 4. Not sure what is wrong. 	<p>Check the storage tank.</p> <p>If tap water is not supplied, close the tap water valve.</p> <p>Open the tap water valve.</p> <p>Call our service department.</p>
Water is leaking	<ol style="list-style-type: none"> 1. Is water coming out of the top cover or the purifier? 	<p>After checking the inside of the product, close the tap water valve, unplug the power cord and call our service department.</p>

System Warranty

Warranty is the responsibility of the re-seller.

This product is warranted for one year from the date of sale against all defects except plastic components, rubber and their assembly there of. In the event of any complaint, please contact your dealer or the nearest company service center.

<p>This warranty is valid only when...</p> <p>The application has not been opened or tampered with, by any unauthorized person.</p> <p>The unit is brought to and taken from the service center at the customer's cost and risk.</p> <p>The guarantee card or cash memo duly signed by the authorised dealer are presented with the complaint</p> <p>The application has been installed, used and maintained in accordance with the instruction manual.</p>	<p>This warranty does not apply for..</p> <p>Damage due to chipping peeling, plating, and denting,</p> <p>Breakage or damage to components of Bakelite, urea, ABS, SAN and such plastic material, rubber parts and cord.</p> <p>The items that are subject to normal wear and tear due to operations.</p> <p>Damage resulting from accidents, mishandling or negligence on part of customer.</p>
---	--



MODEL NAME	SPLASH ALKALINE RO
PURIFYING TECHNOLOGY	REVERSE OSMOSIS (RO) WITH ALKALINE ENRICH TECHNOLOGY
APPLICABLE TDS RANGE IN INPUT WATER	UPTO 1500 MG/LT
INSTALLATION TYPE	TABLE TOP AND WALL MOUNTING
PURIFIED WATER FLOW RATE	8 LIT/HR
STORAGE TANK CAPACITY	8 LITERS (APPROX)
TDS REDUCTION	90% (APPROX)
% WATER RECOVERY	27% APPROX
NET WEIGHT	11.5 KG (APPROX)
OPERATING INPUT	VOLTAGE 230V AC/50HZ
RO MEMBRANE	75 GPD
MEMBRANE TYPE	THIN FILM COMPOSITE RO
BOOSTER PUMP VOLTAGE	24V DC
INPUT WATER TEMPERATURE	5 DEGREE C-45 DEGREE C
INPUT WATER CHLORINE	0.2 MG/LT (MAX)
INPUT WATER IRON	0.3 MG/LT (MAX)
INPUT WATER TURBIDITY	15 NTU (MAX)

Note: Technical Specifications are subject to change without prior notice.
*** Flow rate and other parameters depend on the input water pressure and condition of the filters.**



WARRANTY CARD

Name of Customer: _____

Contact No: (R) _____ (M) _____

Postal Address: _____

Date of invoice: _____ Date of installation: _____

Modal No: _____ Unit No: _____

Membrane No: _____ Pump No: _____

Dealer Stamp & Sign.: _____

 Signature of sales person

 Customer signature



An ISO 9001:2008 Certified Company



Warranty Card

Dear Customer,

Congratulations! You have become a proud owner of Propello Water Purifier, the model mentioned below is covered under warranty against all manufacturing defects for a period of 12 months from the date of purchases subject to the conditions mentioned overleaf.

Model:

Sl No.:

Bill No.:

Purchasing Dealer's Name with signature & seal:

Warranty Terms & Conditions

The goods are warranted against all manufacturing defects for a period of 12 months from the date of purchase subject to the following conditions:

- A. The warranty does not cover items that are subject to normal wear and tear due to operations.
- B. Defective purifier with valid warranty card and original bill to be produced to the authorized service franchise or service dealer by the customer's own cost during working hours.
- C. This warranty does not cover defects as result of accident / damage due to transit or misuse.
- D. This warranty is not applicable if the damage is a result of attractions, unauthorized repairs, tampering or alteration of any part, unauthorized installation or damages caused as a result of natural calamity, riots or any unnatural circumstances.
- E. Consumable items will not be covered under warranty.
- F. This warranty is valid only when it bears the signature and stamp of the authorized dealer.
- G. The defective item or component will be replaced / repaired at the sole discretion of Propello Innovations Pvt. Ltd. And the replaced parts will be the property of Propello Innovations Pvt. Ltd.
- H. This product is intended for domestic use and not for commercial use. The purified water is intended for drinking purpose only and any other use such as bathing, washing etc. will lead to cancellation of warranty.
- I. All disputes are subject to Kolkata jurisdiction.
- J. The machine has a limited purifying capacity designed only for drinking purposes the warranty will not to be valid purified water used for other purposes.

Customer's Signature



SERVICE RECORD

VISIT TYPE : _____ Date : _____ Remarks : _____ _____ _____ _____ _____ _____ _____ Signature _____ Name of service person _____	VISIT TYPE : _____ Date : _____ Remarks : _____ _____ _____ _____ _____ _____ _____ Signature _____ Name of service person _____
VISIT TYPE : _____ Date : _____ Remarks : _____ _____ _____ _____ _____ _____ _____ Signature _____ Name of service person _____	VISIT TYPE : _____ Date : _____ Remarks : _____ _____ _____ _____ _____ _____ _____ Signature _____ Name of service person _____